

Lubricator & Riser Sections



TIS Lubricator & riser sections are pressure retaining cylinders used during well intervention operations, for tool deployment. Sections can be made-up together with an appropriate sealing device, to form an effectual operating height to retain the tool string complete with sub-surface deployment tool(s) being run or Retrieved from the well.

TIS offer two types of lubricator and riser sections

1. Conventional types, typically each assembly comprises of; lubricator tube, double box collar complete with bleed port(s), quick union pin and collar down and quick union box up.
2. Integral types, comprising of a one-piece tube with integral quick union connections and upset containing a bleed port (optional). The quick union collar being retained on to the tube by means of a special TIS segment set.

The TIS lubricator and riser section range is available with the following options

- 3.00" ID, 9.00" ID Through bores.
- 3ft to 20ft length options
- 5,000 Psi, 10,000 Psi and 15,000 Psi working pressures.
- Standard or sour service.
- Service temperature range of -29 to +121 Degrees C.
- Choice of quick union or API flanged connections.
- Choice of bleed port connections.

Technical features include

- On conventional lubricators, the component parts are screwed together by means of a special TIS acme connection, which has a primary o-ring seal and secondary metal to metal seal.
- On integral type lubricators, the quick union collars can be very quickly and easily removed for cleaning, inspection, etc.
- Integral lubricator sections can also be provided with an optional full re-cut facility on quick union connections.



Conventional Lubricators 5,000 & 10,000 psi

Thro' Bore	Working Pressure	Quick Union	Length	1/2" NPT Port	Part Number	Redress Kit
3.00"	5,000 psi	5-1/2"-4x2 'B' Type	6 Feet	None	0037-00030-TIS	0037-00030-KIT
3.00"	5,000 psi	5-1/2"-4x2 'B' Type	8 Feet	None	0037-00031-TIS	0037-00031-KIT
3.00"	5,000 psi	5-1/2"-4x2 'B' Type	10 Feet	None	0037-00032-TIS	0037-00032-KIT
3.00"	5,000 psi	5-1/2"-4x2 'B' Type	6 Feet	1 off	0037-00033-TIS	0037-00033-KIT
3.00"	5,000 psi	5-1/2"-4x2 'B' Type	8 Feet	1 off	0037-00034-TIS	0037-00034-KIT
3.00"	5,000 psi	5-1/2"-4x2 'B' Type	10 Feet	1 off	0037-00035-TIS	0037-00035-KIT
3.00"	5,000 psi	5"-4Thd 'O' Type	6 Feet	None	0037-00036-TIS	0037-00036-KIT
3.00"	5,000 psi	5"-4Thd 'O' Type	8 Feet	None	0037-00037-TIS	0037-00037-KIT
3.00"	5,000 psi	5"-4Thd 'O' Type	10 Feet	None	0037-00038-TIS	0037-00038-KIT
3.00"	5,000 psi	5"-4Thd 'O' Type	6 Feet	1 off	0037-00019-TIS	0037-00019-KIT
3.00"	5,000 psi	5"-4Thd 'O' Type	8 Feet	1 off	0037-00039-TIS	0037-00039-KIT
3.00"	5,000 psi	5"-4Thd 'O' Type	10 Feet	1 off	0037-00018-TIS	0037-00018-KIT
3.00"	10,000 psi	6-5/16"-4Thd 'B' Type	6 Feet	None	0037-00040-TIS	0037-00040-KIT
3.00"	10,000 psi	6-5/16"-4Thd 'B' Type	8 Feet	None	0037-00041-TIS	0037-00041-KIT
3.00"	10,000 psi	6-5/16"-4Thd 'B' Type	10 Feet	None	0037-00042-TIS	0037-00042-KIT
3.00"	10,000 psi	6-5/16"-4Thd 'B' Type	6 Feet	1 off	0037-00043-TIS	0037-00043-KIT
3.00"	10,000 psi	6-5/16"-4Thd 'B' Type	8 Feet	1 off	0037-00044-TIS	0037-00044-KIT
3.00"	10,000 psi	6-5/16"-4Thd 'B' Type	10 Feet	1 off	0037-00004-TIS	0037-00004-KIT
3.00"	10,000 psi	5-3/4"-4Thd 'O' Type	6 Feet	None	0037-00045-TIS	0037-00045-KIT
3.00"	10,000 psi	5-3/4"-4Thd 'O' Type	8 Feet	None	0037-00046-TIS	0037-00046-KIT
3.00"	10,000 psi	5-3/4"-4Thd 'O' Type	10 Feet	None	0037-00047-TIS	0037-00047-KIT
3.00"	10,000 psi	5-3/4"-4Thd 'O' Type	6 Feet	1 off	0037-00048-TIS	0037-00048-KIT
3.00"	10,000 psi	5-3/4"-4Thd 'O' Type	8 Feet	1 off	0037-00015-TIS	0037-00015-KIT
3.00"	10,000 psi	5-3/4"-4Thd 'O' Type	10 Feet	1 off	0037-00003-TIS	0037-00003-KIT

Conventional Lubricators 5,000 & 10,000 psi

Thro' Bore	Working Pressure	Quick Union	Length	1/2" NPT Port	Part Number	Redress Kit
4.00"	5,000 psi	7"-5Thd 'B' Type	6 Feet	None	0016-00019-TIS	0016-00019-KIT
4.00"	5,000 psi	7"-5Thd 'B' Type	8 Feet	None	0016-00020-TIS	0016-00020-KIT
4.00"	5,000 psi	7"-5Thd 'B' Type	10 Feet	None	0016-00021-TIS	0016-00021-KIT
4.00"	5,000 psi	7"-5Thd 'B' Type	6 Feet	1 off	0016-00022-TIS	0016-00022-KIT
4.00"	5,000 psi	7"-5Thd 'B' Type	8 Feet	1 off	0016-00023-TIS	0016-00023-KIT
4.00"	5,000 psi	7"-5Thd 'B' Type	10 Feet	1 off	0016-00024-TIS	0016-00024-KIT
4.00"	5,000 psi	6-1/2"-4Thd 'O' Type	6 Feet	None	0016-00025-TIS	0016-00025-KIT
4.00"	5,000 psi	6-1/2"-4Thd 'O' Type	8 Feet	None	0016-00026-TIS	0016-00026-KIT
4.00"	5,000 psi	6-1/2"-4Thd 'O' Type	10 Feet	None	0016-00027-TIS	0016-00027-KIT
4.00"	5,000 psi	6-1/2"-4Thd 'O' Type	6 Feet	1 off	0016-00028-TIS	0016-00028-KIT
4.00"	5,000 psi	6-1/2"-4Thd 'O' Type	8 Feet	1 off	0016-00029-TIS	0016-00029-KIT
4.00"	5,000 psi	6-1/2"-4Thd 'O' Type	10 Feet	1 off	0016-00030-TIS	0016-00030-KIT
4.00"	10,000 psi	8-1/4"-4x2 'B' Type (10k)	6 Feet	None	0016-00013-TIS	0016-00013-KIT
4.00"	10,000 psi	8-1/4"-4x2 'B' Type (10k)	8 Feet	None	0016-00014-TIS	0016-00014-KIT
4.00"	10,000 psi	8-1/4"-4x2 'B' Type (10k)	10 Feet	None	0016-00015-TIS	0016-00015-KIT
4.00"	10,000 psi	8-1/4"-4x2 'B' Type (10k)	6 Feet	1 off	0016-00016-TIS	0016-00016-KIT
4.00"	10,000 psi	8-1/4"-4x2 'B' Type (10k)	8 Feet	1 off	0016-00017-TIS	0016-00017-KIT
4.00"	10,000 psi	8-1/4"-4x2 'B' Type (10k)	10 Feet	1 off	0016-00018-TIS	0016-00018-KIT
4.00"	10,000 psi	8-3/8"-4 Thd 'O' Type	6 Feet	None	0016-00010-TIS	0016-00010-KIT
4.00"	10,000 psi	8-3/8"-4 Thd 'O' Type	8 Feet	None	0016-00011-TIS	0016-00011-KIT
4.00"	10,000 psi	8-3/8"-4 Thd 'O' Type	10 Feet	None	0016-00012-TIS	0016-00012-KIT
4.00"	10,000 psi	8-3/8"-4 Thd 'O' Type	6 Feet	1 off	0016-00008-TIS	0016-00008-KIT
4.00"	10,000 psi	8-3/8"-4 Thd 'O' Type	8 Feet	1 off	0016-00005-TIS	0016-00005-KIT
4.00"	10,000 psi	8-3/8"-4 Thd 'O' Type	10 Feet	1 off	0016-00009-TIS	0016-00009-KIT

Lubricator & Riser Sections



Conventional Lubricators

5,000 & 10,000 psi

Thro' Bore	Working Pressure	Quick Union	Length	1/2" NPT Port	Part Number	Redress Kit
5.12"	5,000 psi	8-1/4"-4x2'B' Type (5k)	6 Feet	None	0039-00012-TIS	0039-00012-KIT
5.12"	5,000 psi	8-1/4"-4x2'B' Type (5k)	8 Feet	None	0039-00013-TIS	0039-00013-KIT
5.12"	5,000 psi	8-1/4"-4x2'B' Type (5k)	10 Feet	None	0039-00014-TIS	0039-00014-KIT
5.12"	5,000 psi	8-1/4"-4x2'B' Type (5k)	6 Feet	1 off	0039-00015-TIS	0039-00015-KIT
5.12"	5,000 psi	8-1/4"-4x2'B' Type (5k)	8 Feet	1 off	0039-00016-TIS	0039-00016-KIT
5.12"	5,000 psi	8-1/4"-4x2'B' Type (5k)	10 Feet	1 off	0039-00017-TIS	0039-00017-KIT
5.12"	5,000 psi	8-1/4"-4Thd'O' Type	6 Feet	None	0039-00018-TIS	0039-00018-KIT
5.12"	5,000 psi	8-1/4"-4Thd'O' Type	8 Feet	None	0039-00019-TIS	0039-00019-KIT
5.12"	5,000 psi	8-1/4"-4Thd'O' Type	10 Feet	None	0039-00020-TIS	0039-00020-KIT
5.12"	5,000 psi	8-1/4"-4Thd'O' Type	6 Feet	1 off	0039-00021-TIS	0039-00021-KIT
5.12"	5,000 psi	8-1/4"-4Thd'O' Type	8 Feet	1 off	0039-00022-TIS	0039-00022-KIT
5.12"	5,000 psi	8-1/4"-4Thd'O' Type	10 Feet	1 off	0039-00023-TIS	0039-00023-KIT
5.12"	10,000 psi	8-7/8"-4x2'B' Type	6 Feet	None	0039-00028-TIS	0039-00028-KIT
5.12"	10,000 psi	8-7/8"-4x2'B' Type	8 Feet	None	0039-00029-TIS	0039-00029-KIT
5.12"	10,000 psi	8-7/8"-4x2'B' Type	10 Feet	None	0039-00030-TIS	0039-00030-KIT
5.12"	10,000 psi	8-7/8"-4x2'B' Type	6 Feet	1 off	0039-00025-TIS	0039-00025-KIT
5.12"	10,000 psi	8-7/8"-4x2'B' Type	8 Feet	1 off	0039-00026-TIS	0039-00026-KIT
5.12"	10,000 psi	8-7/8"-4x2'B' Type	10 Feet	1 off	0039-00027-TIS	0039-00027-KIT
5.12"	10,000 psi	9"-4Thd'O' Type	6 Feet	None	0039-00031-TIS	0039-00031-KIT
5.12"	10,000 psi	9"-4Thd'O' Type	8 Feet	None	0039-00032-TIS	0039-00032-KIT
5.12"	10,000 psi	9"-4Thd'O' Type	10 Feet	None	0039-00033-TIS	0039-00033-KIT
5.12"	10,000 psi	9"-4Thd'O' Type	6 Feet	1 off	0039-00024-TIS	0039-00024-KIT
5.12"	10,000 psi	9"-4Thd'O' Type	8 Feet	1 off	0039-00009-TIS	0039-00009-KIT
5.12"	10,000 psi	9"-4Thd'O' Type	10 Feet	1 off	0039-00005-TIS	0039-00005-KIT

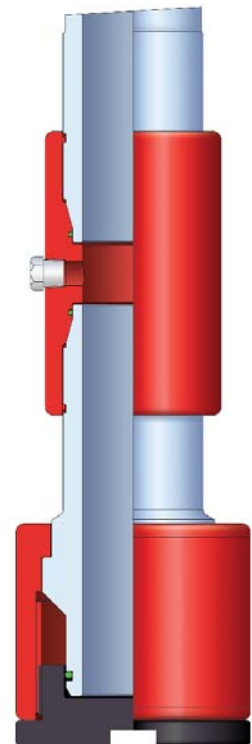
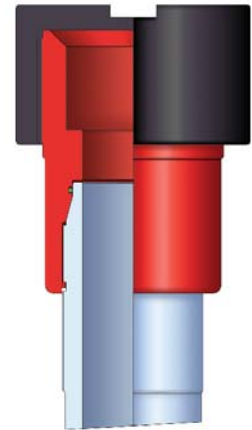

Conventional Lubricator

Conventional Lubricators

5,000 & 10,000 psi

Thro' Bore	Working Pressure	Quick Union	Length	1/2" NPT Port	Part Number	Redress Kit
6-5/8"	5,000 psi	9-1/2"-4Thd'O' Type	6 Feet	None	0038-00017-TIS	0038-00017-KIT
6-5/8"	5,000 psi	9-1/2"-4Thd'O' Type	8 Feet	None	0038-00018-TIS	0038-00018-KIT
6-5/8"	5,000 psi	9-1/2"-4Thd'O' Type	10 Feet	None	0038-00019-TIS	0038-00019-KIT
6-5/8"	5,000 psi	9-1/2"-4Thd'O' Type	6 Feet	1 off	0038-00020-TIS	0038-00020-KIT
6-5/8"	5,000 psi	9-1/2"-4Thd'O' Type	8 Feet	1 off	0038-00021-TIS	0038-00021-KIT
6-5/8"	5,000 psi	9-1/2"-4Thd'O' Type	10 Feet	1 off	0038-00022-TIS	0038-00022-KIT
6-5/8"	5,000 psi	9-7/8"-4x2'B' Type	6 Feet	None	0038-00014-TIS	0038-00014-KIT
6-5/8"	5,000 psi	9-7/8"-4x2'B' Type	8 Feet	None	0038-00015-TIS	0038-00015-KIT
6-5/8"	5,000 psi	9-7/8"-4x2'B' Type	10 Feet	None	0038-00016-TIS	0038-00016-KIT
6-5/8"	5,000 psi	9-7/8"-4x2'B' Type	6 Feet	1 off	0038-00024-TIS	0038-00024-KIT
6-5/8"	5,000 psi	9-7/8"-4x2'B' Type	8 Feet	1 off	0038-00025-TIS	0038-00025-KIT
6-5/8"	5,000 psi	9-7/8"-4x2'B' Type	10 Feet	1 off	0038-00023-TIS	0038-00023-KIT
6-5/8"	10,000 psi	11-1/2"-4 Thd'O' Type	6 Feet	None	0038-00011-TIS	0038-00011-KIT
6-5/8"	10,000 psi	11-1/2"-4 Thd'O' Type	8 Feet	None	0038-00012-TIS	0038-00012-KIT
6-5/8"	10,000 psi	11-1/2"-4 Thd'O' Type	10 Feet	None	0038-00013-TIS	0038-00013-KIT
6-5/8"	10,000 psi	11-1/2"-4 Thd'O' Type	6 Feet	1 off	0038-00004-TIS	0038-00004-KIT
6-5/8"	10,000 psi	11-1/2"-4 Thd'O' Type	8 Feet	1 off	0038-00001-TIS	0038-00001-KIT
6-5/8"	10,000 psi	11-1/2"-4 Thd'O' Type	10 Feet	1 off	0038-00003-TIS	0038-00003-KIT
6-5/8"	10,000 psi	13"-4Thd'B' Type	6 Feet	None	0038-00008-TIS	0038-00008-KIT
6-5/8"	10,000 psi	13"-4Thd'B' Type	8 Feet	None	0038-00009-TIS	0038-00009-KIT
6-5/8"	10,000 psi	13"-4Thd'B' Type	10 Feet	None	0038-00010-TIS	0038-00010-KIT
6-5/8"	10,000 psi	13"-4Thd'B' Type	6 Feet	1 off	0038-00005-TIS	0038-00005-KIT
6-5/8"	10,000 psi	13"-4Thd'B' Type	8 Feet	1 off	0038-00006-TIS	0038-00006-KIT
6-5/8"	10,000 psi	13"-4Thd'B' Type	10 Feet	1 off	0038-00007-TIS	0038-00007-KIT